

H 2861 B

Built-in 60 cm oven with a timer, automatic programmes and AirFry mode



- Built-in oven with a broad range of operating modes from Fan Grill to Conventional Heat for all types of traditional bread and roasted dishes
- Automatic programmes for guided cooking results
- Dedicated AirFry function and recipes that offer crunchy and crisp results
- Lots of room and flexibility – 76 l oven capacity on 5 levels
- Protects against burns – touch-cool front door
- Network-enabled WiFi appliance Miele@home

EAN: 4002516647836 / Material number: 12174510

Construction type and design	
Built-in Oven	•
PureLine	•
Appliance Colour	Stainless steel/Clean Steel
Non-retractable knobs	•
Convenience features	
Rapid heat-up	•
Operating modes	
Automatic programmes	•
Eco fan heat	•
Grill	•
Fan plus	•
Intensive bake	•
Conventional heat	•
Bottom heat	•
Fan grill	•
AirFry	•
User convenience	
Display	EasyControl Plus
SoftOpen	•
SoftClose	•
Time of day display	•
Minute minder	•
Programmable start of cooking duration	•
Programmable end of cooking duration	•
Actual temperature display	•
Target temperature display	•
Audible signal when desired temperature is reached	•
Recommended temperature	•
Individual settings	•
Multilingua	•
Networking with Miele@home	•
Efficiency and sustainability	
Residual heat utilisation	•
Cleaning and care	
Stainless steel/CleanSteel finish	•
CleanGlass door	•
Safety	
Appliance cooling system and touch-cool front door	•
Safety switch-off	•
System lock	•
Technical data	
Oven compartment volume in l	76
No. of shelf levels	5
Numbered shelf levels	•
Oven light	1 halogen spot
Electronic temperature regulation min. in °C	30
Electronic temperature regulation max. in °C	300

H 2861 B

Built-in 60 cm oven with a timer, automatic programmes and AirFry mode



EAN: 4002516647836 / Material number: 12174510

Technical data	
Niche width min. in mm	560
Niche width max. in mm	568
Niche height min. in mm	590
Niche height max. in mm	595
Niche depth in mm	550
Appliance width in mm	595
Appliance height in mm	596
Appliance depth in mm	569.3
Weight in kg	42
Total rated load in kW	3.60
Voltage in V	220-240
Frequency in Hz	50
Number of phases	1
Fuse rating in A	16
Length of supply lead in m	1.50
Accessories supplied	
Baking tray with PerfectClean	1
Universal tray with PerfectClean	1
Wire rack	2
FlexiClip runners with PerfectClean	1
Removable side runners (pair)	1

H 2861 B Installation diagrams

Installation in a tall or base unit

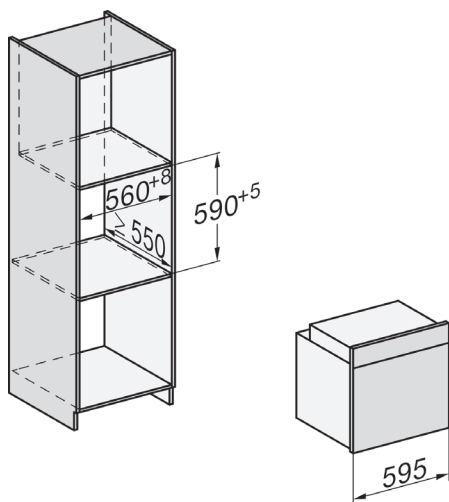

Side view

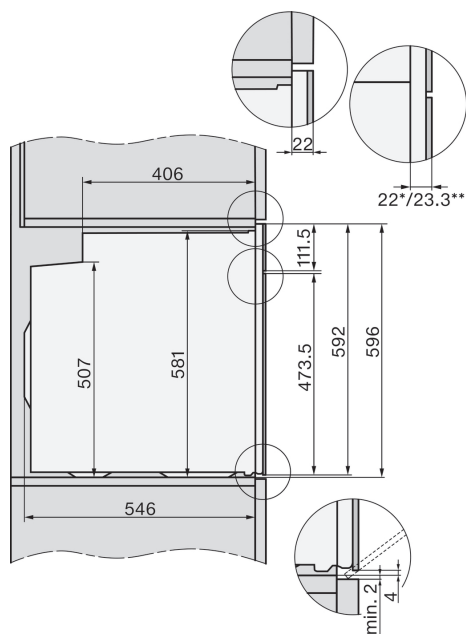

Connection and ventilation

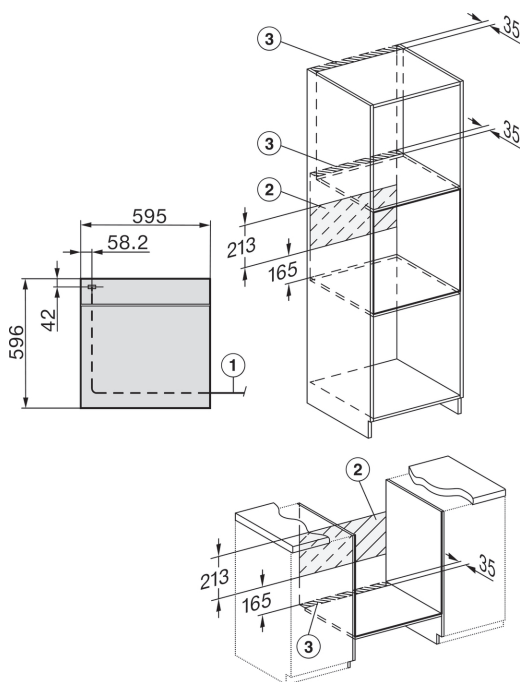

All dimensions are given in mm

- Key:
1. Mains connection cable, length = 1,500 mm
 2. No connections permitted in this area
 3. Ventilation cut-out, min 150 cm²